

# ADVANCED FEATURE DIE/KNIFE CUTTER HEAD ASSEMBLY

A self-adjusting cutter head system that can be used across the full spectrum of wear plates.

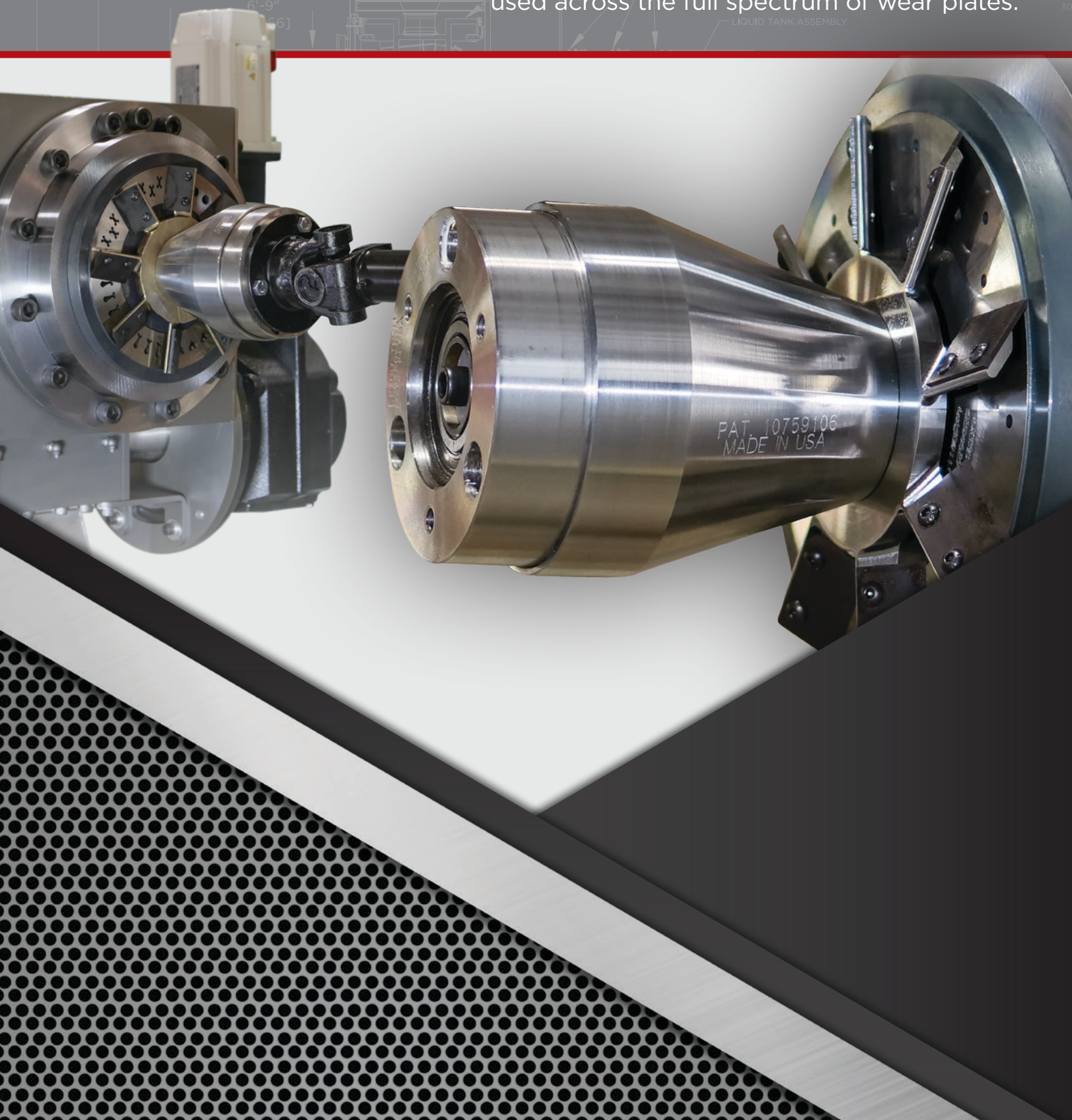

# A self-adjusting Die/Knife Cutter System that will dramatically reduce maintenance costs and downtime.

## 1. SELF-ADJUSTING

Cleaner cut than cast blade configuration due to "precision" pressure pack.

## 2. REPLACEABLE CUTTER BLADE

Individually replaceable blades, which can be sharpened 3-5 times.

## 3. SAFER HANDLING

One cutting edge to minimize risk of injury to personnel.

## 4. FASTER CHANGE OVER

The assembly is secured and automatically set parallel to the wear plate by one bolt.

## 5. SELF-LEVELING

Can accommodate non-perpendicular die stubs or improperly installed plates.

## 6. LONGER LIFE BLADES

Reported tons cut on single edge with new wear plate have been reported to last 2.5-10 times longer than cast blades.

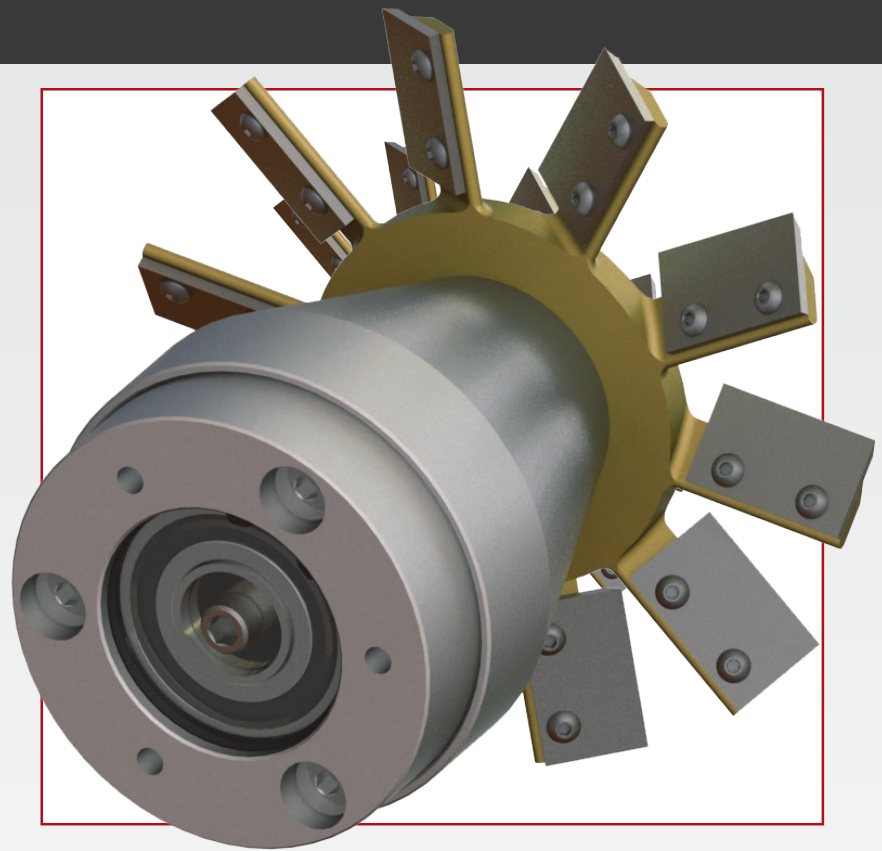

## 7. EASE OF MAINTENANCE

Sealed, wash-down, stainless steel bearings, and no external seals to maintain.

## 8. LOWER OVERALL COST

With the automatic adjustment of the flywheel, one self-adjusting cutter head systems can be used on multiple dies.

## 9. PROTECTED UNDER US PATENT 10759106

Made in the USA.

**Transforming the way food is processed through  
food science and process solution expertise.**

**Contact Wenger or Extru-Tech today.**



15 COMMERCE DRIVE  
SABETHA, KANSAS 66534 USA  
PHONE: +1 785 284 2133  
EMAIL: [INFO@WENGER.COM](mailto:INFO@WENGER.COM)  
[WENGER.COM](http://WENGER.COM)



100 AIRPORT ROAD  
SABETHA, KANSAS 66534 USA  
PHONE: +1 785 284 2153  
[EXTRU-TECHINC@EXTRU-TECHINC.COM](mailto:EXTRU-TECHINC@EXTRU-TECHINC.COM)  
[EXTRU-TECHINC.COM](http://EXTRU-TECHINC.COM)

